

VICTROLATM

5-IN-1 TURNTABLE

MODEL: VTA-60



Instruction Manual

PLEASE READ THIS INSTRUCTION MANUAL CAREFULLY BEFORE USE
AND KEEP IT FOR FUTURE REFERENCE.

WARNING

TO PREVENT FIRE OR SHOCK HAZARD, DO NOT USE THIS PLUG WITH AN EXTENSION CORD, RECEPTACLE OR OTHER OUTLET UNLESS THE BLADES CAN BE FULLY INSERTED TO PREVENT BLADE EXPOSURE. TO PREVENT FIRE OR SHOCK HAZARD, DO NOT EXPOSE THIS APPLIANCE TO RAIN OR MOISTURE.

| | | |
|---|--|---|
|  <p>The lightning flash with arrowhead symbol, within an equilateral triangle is intended to alert the user to the presence of uninsulated dangerous voltage within the product's enclosure that may be of sufficient magnitude to constitute a risk of electric shock to persons.</p> | <div>CAUTION</div> <div>RISK OF ELECTRIC SHOCK</div> <div>DO NOT OPEN</div> <p>CAUTION TO REDUCE THE RISK OF ELECTRIC SHOCK, DO NOT REMOVE COVER (OR BACK). NO USER-SERVICEABLE PARTS INSIDE. REFER SERVICING TO QUALIFIED SERVICE PERSONNEL.</p> |  <p>The exclamation point within an equilateral triangle is intended to alert the user to the presence of important operating and maintenance (servicing) instructions in the literature accompanying the appliance.</p> |
|---|--|---|

The Caution Marking is located at the bottom enclosure of the apparatus.
The Rating plate is located at the bottom enclosure of the apparatus

IMPORTANT SAFETY INSTRUCTIONS

1. Read these instructions.
2. Keep these instructions.
3. Heed all warnings.
4. Follow all instructions.
5. Do not use this apparatus near water.
6. Clean only with dry cloth.
7. Do not block any ventilation openings. Install in accordance with the manufacturer's instructions.
8. Do not install near any heat sources such as radiators, heat registers, stoves, or other apparatus (including amplifiers) that produce heat.
9. Do not defeat the safety purpose of the polarized or grounding-type plug. A polarized plug has two blades with one wider than the other. A grounding type plug has two blades and a third grounding prong. The wide blade or the third prong is provided for your safety. If the provided plug does not fit into your outlet, consult an electrician for replacement of the obsolete outlet.
10. Protect the power cord from being walked on or pinched particularly at plugs, convenience receptacles, and the point where they exit from the apparatus.
11. Only use attachments/accessories specified by the manufacturer.
12. Use only with a cart, stand, tripod, bracket, or table recommended by the manufacturer, or sold with the product. When a cart is used, use caution when moving the cart/apparatus combination to avoid injury from tip-over.
13. Unplug this apparatus during lightning storms or when unused for long periods of time.
14. Refer all servicing to qualified service personnel. Servicing is required when the apparatus has been damaged in any way, such as power-supply cord or plug is damaged, liquid has been spilled or objects have fallen into the apparatus, the apparatus has been exposed to rain or moisture, does not operate normally, or has been dropped.
15. This appliance shall not be exposed to dripping or splashing water and that



- no object filled with liquids such as vases shall be placed on the apparatus.
16. Do not overload wall outlet. Use only power source as indicated.
 17. Use replacement part as specified by the manufacturer.
 18. Upon completion of any service or repairs to this product, ask the service technician to perform safety checks.
 19. Power Sources - This product should be operated only from the type of power source indicated on the marking label. If you are not sure of the type of power supply to your home, consult your product dealer or local power company. For products intended to operate from battery power, or other sources, refer to the operating instruction.
 20. Object and Liquid Entry - Never push objects of any kind into this product through openings as they may touch dangerous voltage points or short-out parts that could result in a fire or electric shock. Never spill liquid of any kind on the product.
 21. Damage Requiring Service - Unplug this product from the wall outlet and refer servicing to qualified service personnel under the following conditions:
 - a) When the power-supply cord or plug is damaged,
 - b) If liquid has been spilled, or objects have fallen into the product,
 - c) If the product has been exposed to rain or water,
 - d) If the product does not operate normally by following the operating instructions. Adjust only those controls that are covered by the operating instructions as an improper adjustment of other controls may result in damage and will often require extensive work by a qualified technician to restore the product to its normal operation.
 - e) If the product has been dropped or damaged in any way, and
 - f) When the product exhibits a distinct change in performance - this indicates a need for service.
 22. Mains plug is used as disconnect device and it should remain readily operable during intended use. In order to disconnect the apparatus from the mains completely, the mains plug should be disconnected from the mains socket outlet completely.
 23. Battery shall not be exposed to excessive heat such as sunshine, fire or the like.
 24. Excessive sound from earphones and headphone can cause hearing loss.
 25. Minimum distances of 10 cm around the apparatus for sufficient ventilation.
 26. The ventilation should not be impeded by covering the ventilation openings with items, such as newspapers, table-cloths, curtains, etc.
 27. No naked flame sources, such as lighted candles, should be placed on the apparatus.
 28. The use of apparatus in moderate climates.
 29. Attention should be drawn to the environmental aspects of battery disposal.

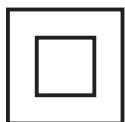

This symbol indicates that this product incorporates double insulation between hazardous mains voltage and user accessible parts.

CAUTION:
TO PREVENT ELECTRIC SHOCK, SELECT PROPER
ADAPTOR PLUG AND FULLY INSERT.

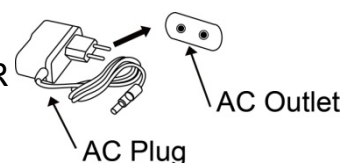

WARNING

Changes or modifications to this unit not expressly approved by the party responsible for compliance could void the user's authority to operate the equipment.

CAUTION

CLASS 1 LASER PRODUCT

CLASS 1 LASER PRODUCT
APPAREIL LASER DE CLASSE 1
PRODUCTO LASER DE CLASE 1

CAUTION
INVISIBLE LASER RADIATION
WHEN OPEN AND INTERLOCKS
DEFEATED.
AVOID EXPOSURE TO BEAM



This product contains a low power laser device.

Follow the advice below for safe operations on protection against laser energy exposure

- As the laser beam used in this compact disc player is harmful to the eyes, do not attempt to disassemble the casing.
- Stop operation immediately if any liquid or solid object should fall into the cabinet.
- Do not touch the lens or poke at it. If you do, you may damage the lens and the player may not operate properly.
- Do not put anything in the safety slot. If you do, the laser diode will be ON when the CD door is still open.
- If the unit is not to be used for a long period of time, make sure that all power sources are disconnected from the unit. Remove all batteries from the battery compartment.
- This unit employs a laser. The use of controls or adjustment or performance of procedures other than those specified here may result in exposure to hazardous radiation.
- Should any trouble occur, remove the power source and refer servicing to qualified personnel.

CAUTION:

This unit should not be adjusted or repaired by anyone except qualified service personnel.



WEEE marking

Disposal of your old product

Your product is designed and manufactured with high quality materials and components, which can be recycled and reused. When this crossed out wheeled bin symbol is attached to a product it means the product is covered by the European Directive 2002/96/EC. Please make yourself aware of the local collection system for electrical and electronic products. Please act according to your local rules and do not dispose of your old products with your normal household waste. The correct disposal of your old product will help prevent potential negative consequences for the environment and human health.



This appliance complies with the following directives: 2014/53/EU: radio equipment directive

You can download the complete EU conformity declaration from www.victrola.com/eudoc

HOW TO INSTALL / REMOVE POWER ADAPTOR PLUG

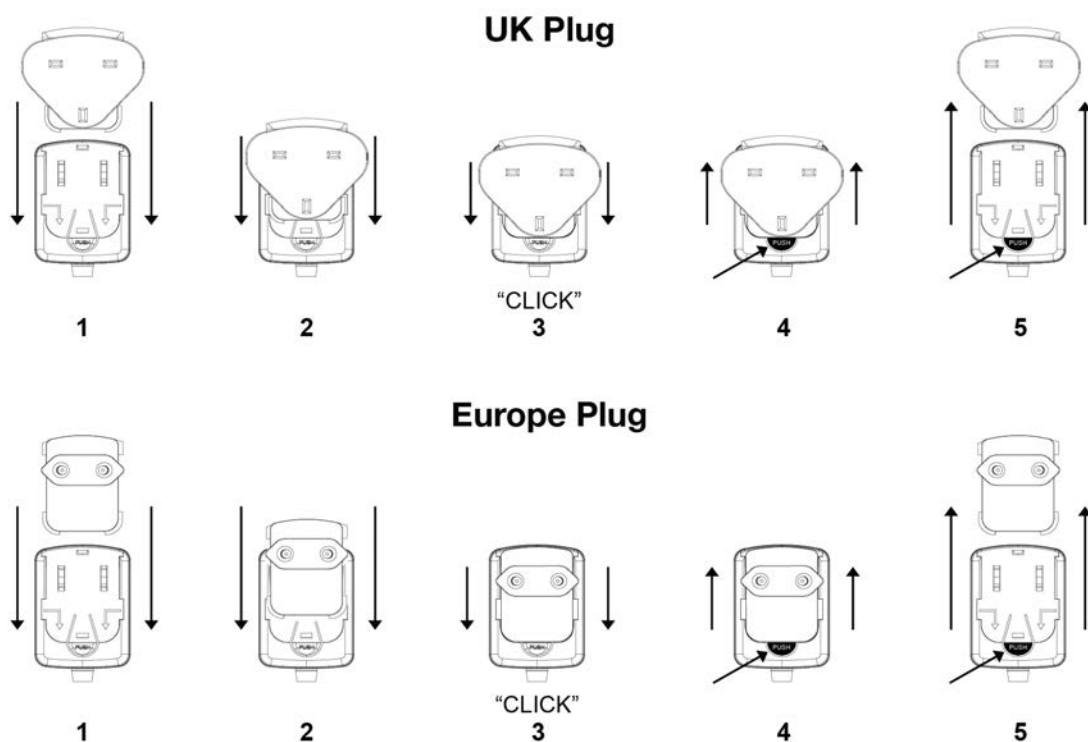

GETTING STARTED

SET UP

An AC/DC adaptor with an output of 12 DC 2.0A is included with the unit. This adaptor is required for operating the unit.

1. Firmly and securely insert the DC plug of the adaptor to the DC IN jack on the back of the unit.
2. Plug the adaptor's AC plug into a power outlet rated at 100-240V AC~50/60Hz. The POWER LED INDICATOR will light up in RED.
3. Press and hold the Power On/Off Button to turn on the unit. The POWER LED INDICATOR will turn off.

LOCATION OF CONTROLS

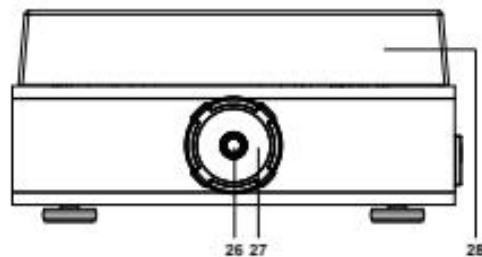
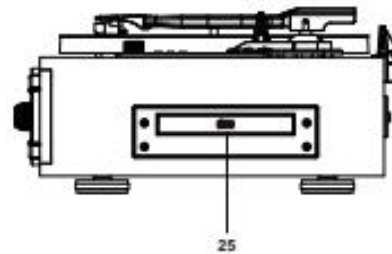
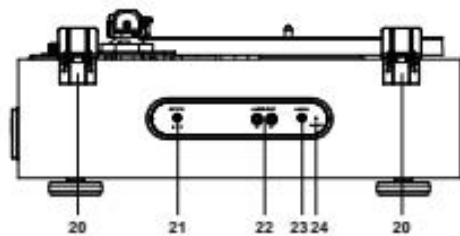
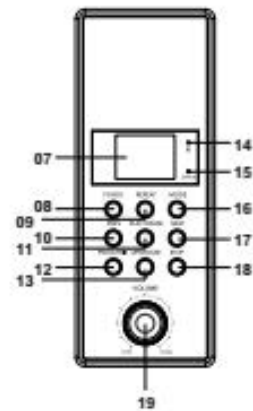
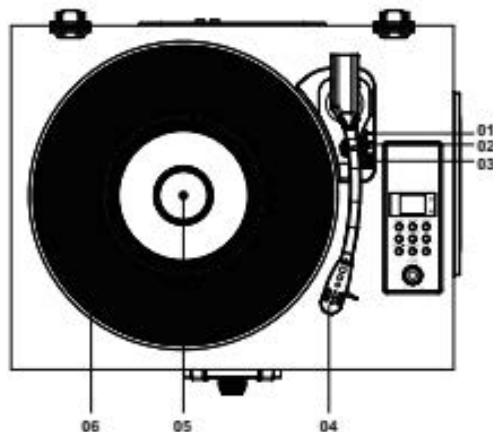

1. Lift Lever
2. Auto Stop On/Off Selection Switch
3. Speed Selection Switch
4. Needle Cartridge
5. Turntable Shaft
6. Turntable Platter
7. LED Display
8. Power on/off Button
9. Repeat Button
10. Previous Button
11. Play/Pause Button
12. Prog/Pairing Button
13. Open/Close Button
14. Bluetooth Pairing LED Indicator

15. Power LED Indicator
16. Mode Button
17. Next Button
18. Stop Button
19. Volume Control Knob
20. Dust Cover Hinge
21. DC power adaptor Jack
22. RCA Jack
23. 3.5mm Aux-in Jack
24. FM Pigtail Antenna
25. CD Door
26. Dial Knob
27. Dial Scale
28. Dust Cover

TURNTABLE OPERATION

BASIC OPERATION

Before use, be sure to remove the white stylus guard off of the needle. Always make sure that the tone arm is unlocked and free to move across the record while operating. Lock the tone arm in place again when it is not in use.

1. Press the MODE BUTTON to enter PHONO mode, the LED DISPLAY will indicate "PH".
2. Place a record on the TURNTABLE PLATTER and select the desired speed (33/45/78) by sliding the SPEED SELECTION SWITCH according to the record.

NOTE: When playing a 45 RPM record, use the included 45 RPM ADAPTOR located in the holder near the tone arm.

3. Open the TONE ARM CLIP to release the TONE ARM. Push the LIFT LEVER backward to raise the TONE ARM and gently move the TONE ARM to the desired position over the record. The turntable will begin to spin when the arm is moved toward the record. Push the LIFT LEVER forward to lower the TONE ARM slowly onto the desired position on the record to begin playing the record.

NOTE: The record will begin to spin only when the tone arm is moved over the record if Auto Stop is turned ON.

If the AUTO AND MANUAL STOP SELECTION SWITCH is turned ON, the record will stop automatically when finished. If this switch is at OFF position, record will continue to spin.

4. To select the volume level, turn the VOLUME CONTROL KNOB to adjust the volume.

How to Replace the Turntable Stylus (Replacement Needle # ITNP-Y2)

The stylus should last about 50 hours under normal use. However, it is recommended that the stylus be replaced as soon as you notice a change in sound quality. Prolonged use of a worn-out stylus may damage the record. The highest speed of 78 RPM records would wear out the stylus more quickly.

Removing the Stylus from the Cartridge

1. Set a screwdriver at the tip of the stylus and push down to the direction "A".

***WARNING:** When applying force to stylus, too much may damage or break the stylus.*

2. Pull the stylus out toward the direction "B".

Installing the Stylus

1. Hold the tip of the stylus and insert the other edge by pressing toward direction "C".
2. Push the stylus up toward direction "D" until it locks at the tip.

Caution:

- Do not remove or bend the stylus needle.
- Do not touch the needle to avoid injury to your hand.
- Turn off the unit's power before you replace the stylus.
- Keep out of reach of children.

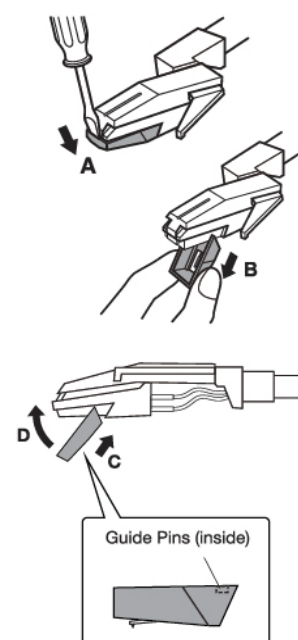

RADIO OPERATION

1. Press the MODE BUTTON to enter RADIO mode, the LED DISPLAY will indicate "rA".
2. Turn the RADIO DIAL KNOB to tune to the station you want to listen to.
3. Rotate the VOLUME CONTROL KNOB to the desired volume level.
4. To turn off the Radio press the POWER BUTTON to turn off the unit or press the MODE BUTTON to switch to a different mode.

Tips for Best Reception:

The receiver has a build-in FM PIGTAIL ANTENNA hanging on the back of the unit. This wire should be unraveled and extended for best reception.

BLUETOOTH OPERATION

1. Press the MODE BUTTON to enter Bluetooth mode, the LED DISPLAY will indicate "bt". The BLUETOOTH LED INDICATOR will flash in blue color.
2. Turn on your external Bluetooth device to pair with the unit. Go to your device's Bluetooth Menu and select Bluetooth pairing name "**VTA-60**" to connect the unit. Once connected, the blue Led light will stop flashing.
3. Select desired songs on your Bluetooth device.
4. To select the volume level, either turn the VOLUME CONTROL KNOB to adjust the volume or adjust from your Bluetooth device.
5. If you want to disconnect the Bluetooth connection, you can press and hold the PROG/PAIR BUTTON for 3 seconds.

NOTE: Playback functions such as Prev, Next and Play/Pause on the main unit can be used in Bluetooth mode.

CD OPERATION

NOTE: THIS UNIT NOT ONLY PLAYS COMMERCIAL COMPACT DISCS BUT ALSO SELF-COMPILED CD-RW DISCS.

PLEASE READ THIS IMPORTANT INFORMATION:

CD mechanisms used in devices like this are designed to fully read all commercial CDs. They will also read self-compiled CD-R/CD-RW discs but it may take up to 10 seconds for playback to start. If playback does not start, it is likely due to the quality of the CD-R/RW disc and/or the compatibility of the CD compilation software. Manufacturer is not responsible for the playback quality of CD-R/RW discs.

Do not attach a label or seal to either side of the CD-R/RW disc. It may cause a malfunction.

PLAYING A CD

1. Press the MODE BUTTON to enter CD mode, the LED DISPLAY will indicate "CD".
2. Press CD DOOR OPEN/CLOSE BUTTON to open the disc tray.
3. Carefully place an audio CD with its label side upward on the tray.
4. Press CD DOOR OPEN/CLOSE BUTTON to close the tray, the LED

DISPLAY will indicate the number of tracks on the disc. If there is no disc inserted, it will indicate "no".

5. Press PLAY/PAUSE to start playing the first track.
6. To pause playback, press the PLAY/PAUSE BUTTON. To resume playing press PLAY/PAUSE BUTTON again.
7. You can choose to play your favorite track directly by pressing either the PREV BUTTON or NEXT BUTTON. The LED DISPLAY will indicate the current track number selected.
8. To locate a particular section within a track, press and hold the PREV BUTTON or NEXT BUTTON until the section is found. Release the button to continue playing your selection.
9. To stop playing, press the STOP BUTTON.

REPEAT MODE

REPEAT 1

When the REPEAT BUTTON is pressed once, the REPEAT LED INDICATOR on the LED DISPLAY will flash in RED. The current selected track will be played on repeat.

REPEAT ALL

When the REPEAT BUTTON is pressed twice, the REPEAT LED INDICATOR on the LED DISPLAY will light up in RED. The whole disc will be played on repeat.

CD PROGRAM PLAY MODE

This function allows the CD tracks to be played in a programmed sequence.

NOTE: Program can only be set in STOP mode.

1. Load the CD Disc you wish to program.
2. Make sure the unit is in STOP mode by pressing the STOP BUTTON.
3. Press the PROGRAM/PAIR BUTTON once, the LED DISPLAY will flash "00" on the LED DISPLAY.
4. Press PREV BUTTON or NEXT BUTTON until the desired track number is reached.
5. Press the PROGRAM/PAIR BUTTON again to store the selection.
6. Repeat the (4) to (5) steps until you have entered all the tracks you want to program.
7. To play the stored sequence, press the PLAY/PAUSE BUTTON.
8. After all the stored tracks have been played the CD will automatically stop.

NOTES:

- When 20 tracks of CD music have been programmed, the memory is full and "FUL" will be indicated on the LED DISPLAY.
- If you want to cancel the program memory, you need to disconnect the power adaptor from the unit.
- The Repeat function also applies to programmed playback.
To repeat programmed tracks:
 1. During program play, press REPEAT BUTTON once will repeat the specifically programmed tracks.
 2. Press the REPEAT BUTTON again to repeat all the programmed tracks.

AUXILIARY INPUT

Use the AUX-IN JACK to connect external audio devices like MP3 players, CD players and the older, non-dockable iPod to listen through the speakers of this system.

1. Use a 3.5mm Aux-in cable (not included) to plug one end into the AUX-IN JACK at the rear of the unit and the other end of the cable into the Line-out Jack or Headphone Jack of your external audio device.
2. Turn on the VTA-60 and your external audio device.
3. Press the MODE BUTTON to enter Aux-in mode, the LED DISPLAY will indicate "AU".
4. The volume level can be controlled through the main unit.
Operate all other functions on the external device as usual.

RCA OUTPUT

For amplifier device with RCA auxiliary input sockets, insert the white and red plugs on the RCA cable (not included) into the unit. Insert the opposite end into the amplifier device. Be sure to connect the white plug to the white jack and the red plug to the red jack.

SPECIFICATIONS

| | |
|----------------------------|--|
| Power Supply: | AC adaptor: 100-240V, 50/60Hz DC-12V/2.0A |
| Speaker Impedance: | 3" 8ohm 3W |
| Freq. Range: | 88-108 MHz |
| Max Power Consumption: | 30W |
| Bluetooth frequency range: | 2.402GHZ-2.480GHZ |
| Bluetooth transmit power: | CLASS2, 4dbm |
| Size: | 17" (431mm) W x 13.25" (336mm) D x 8" (203mm) |
| Weight: | 11.5 lbs (5.2kg) |
| Included: | Turntable, Instruction Manual, Turntable Operation Sheet, 12V/2.0A Switching Power Supply with 2 plugs, 45 RPM Adaptor, Felt Mat |

Made in China.

Design and specification are subject to change without notice.

Bluetooth is a registered trademark of Bluetooth SIG, Inc.

Other trademarks and trade names are those of their respective owners.

This product is manufactured and sold by Innovative Technology Electronics LLC. Victrola and the Victrola logo are trademarks of Technicolor or its affiliates and are used under license by Innovative Technology Electronics LLC. Any other product, service, company, trade or product name and logo referenced herein are neither endorsed nor sponsored by Technicolor or its affiliates.

Imported by:

Exertis Supply Chain Services Ltd.

M50 Business Park, Ballymount Rd. Upper, Dublin 12, D12 T4C2, Ireland